

Stationing
1398
1396

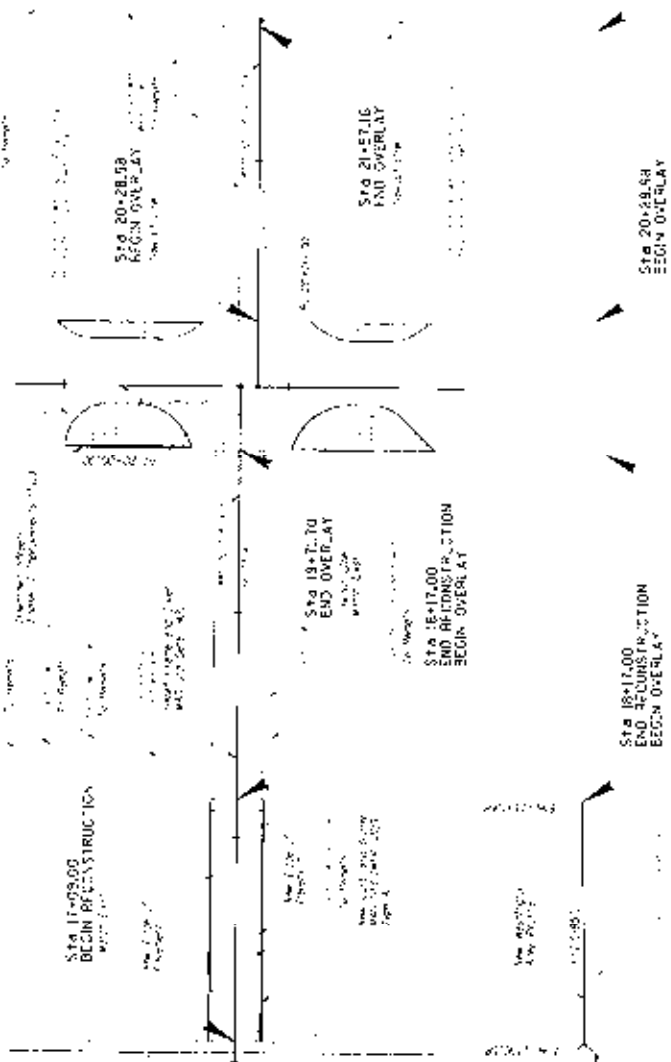

LIST OF QUANTITIES

- 444.30 cu. Concrete Slabs
- 444.30 cu. Concrete Curbs
- 577.50 cu. Concrete of Various Shapes
- 1.20 cu. Concrete
- 1.20 cu. Concrete
- 1.20 cu. Concrete

16

18

19

20

21

Professional Engineer's Seal and Title Block. The seal is circular and contains the text "Professional Engineer" and "State of California". To the right of the seal is the text "Professional Engineer" and "State of California". Below this is the name "JAMES H. HARRIS" and the number "12345".

ANNEX 1.1.2

1. CONDUCT AN ASSESSMENT OF THE MARKET FOR THE PROPOSED PROJECT AND THE LOCAL COMMUNITY, INCLUDING THE IDENTIFICATION OF POTENTIAL BENEFICIARIES AND THE IDENTIFICATION OF POTENTIAL RISKS TO THE PROJECT AND THE COMMUNITY.
2. DESIGN AND DEVELOP A COMMUNITY DEVELOPMENT PLAN, INCLUDING THE IDENTIFICATION OF POTENTIAL BENEFICIARIES AND THE IDENTIFICATION OF POTENTIAL RISKS TO THE PROJECT AND THE COMMUNITY.
3. IDENTIFY AND CONTACT THE COMMUNITY DEVELOPMENT PLAN, INCLUDING THE IDENTIFICATION OF POTENTIAL BENEFICIARIES AND THE IDENTIFICATION OF POTENTIAL RISKS TO THE PROJECT AND THE COMMUNITY.
4. IDENTIFY AND CONTACT THE COMMUNITY DEVELOPMENT PLAN, INCLUDING THE IDENTIFICATION OF POTENTIAL BENEFICIARIES AND THE IDENTIFICATION OF POTENTIAL RISKS TO THE PROJECT AND THE COMMUNITY.
5. IDENTIFY AND CONTACT THE COMMUNITY DEVELOPMENT PLAN, INCLUDING THE IDENTIFICATION OF POTENTIAL BENEFICIARIES AND THE IDENTIFICATION OF POTENTIAL RISKS TO THE PROJECT AND THE COMMUNITY.
6. IDENTIFY AND CONTACT THE COMMUNITY DEVELOPMENT PLAN, INCLUDING THE IDENTIFICATION OF POTENTIAL BENEFICIARIES AND THE IDENTIFICATION OF POTENTIAL RISKS TO THE PROJECT AND THE COMMUNITY.
7. IDENTIFY AND CONTACT THE COMMUNITY DEVELOPMENT PLAN, INCLUDING THE IDENTIFICATION OF POTENTIAL BENEFICIARIES AND THE IDENTIFICATION OF POTENTIAL RISKS TO THE PROJECT AND THE COMMUNITY.
8. IDENTIFY AND CONTACT THE COMMUNITY DEVELOPMENT PLAN, INCLUDING THE IDENTIFICATION OF POTENTIAL BENEFICIARIES AND THE IDENTIFICATION OF POTENTIAL RISKS TO THE PROJECT AND THE COMMUNITY.
9. IDENTIFY AND CONTACT THE COMMUNITY DEVELOPMENT PLAN, INCLUDING THE IDENTIFICATION OF POTENTIAL BENEFICIARIES AND THE IDENTIFICATION OF POTENTIAL RISKS TO THE PROJECT AND THE COMMUNITY.

Item No.	Description	Quantity	Unit Price	Total
1	Site preparation	1	50000	50000
2	Construction of 2000 sqm	1	100000	100000
3	Construction of 1000 sqm	1	50000	50000
4	Construction of 500 sqm	1	25000	25000
5	Construction of 250 sqm	1	12500	12500
6	Construction of 125 sqm	1	6250	6250
7	Construction of 62.5 sqm	1	3125	3125
8	Construction of 31.25 sqm	1	1562.5	1562.5
9	Construction of 15.625 sqm	1	781.25	781.25
10	Construction of 7.8125 sqm	1	390.625	390.625
11	Construction of 3.90625 sqm	1	195.3125	195.3125
12	Construction of 1.953125 sqm	1	97.65625	97.65625
13	Construction of 0.9765625 sqm	1	48.828125	48.828125
14	Construction of 0.48828125 sqm	1	24.4140625	24.4140625
15	Construction of 0.244140625 sqm	1	12.20703125	12.20703125
16	Construction of 0.1220703125 sqm	1	6.103515625	6.103515625
17	Construction of 0.06103515625 sqm	1	3.0517578125	3.0517578125
18	Construction of 0.030517578125 sqm	1	1.52587890625	1.52587890625
19	Construction of 0.0152587890625 sqm	1	0.762939453125	0.762939453125
20	Construction of 0.00762939453125 sqm	1	0.3814697265625	0.3814697265625
21	Construction of 0.003814697265625 sqm	1	0.19073486328125	0.19073486328125
22	Construction of 0.0019073486328125 sqm	1	0.095367431640625	0.095367431640625
23	Construction of 0.00095367431640625 sqm	1	0.0476837158203125	0.0476837158203125
24	Construction of 0.000476837158203125 sqm	1	0.02384185791015625	0.02384185791015625
25	Construction of 0.0002384185791015625 sqm	1	0.011920928955078125	0.011920928955078125
26	Construction of 0.00011920928955078125 sqm	1	0.0059604644775390625	0.0059604644775390625
27	Construction of 0.000059604644775390625 sqm	1	0.00298023223876953125	0.00298023223876953125
28	Construction of 0.0000298023223876953125 sqm	1	0.001490116119384765625	0.001490116119384765625
29	Construction of 0.00001490116119384765625 sqm	1	0.0007450580596923828125	0.0007450580596923828125
30	Construction of 0.000007450580596923828125 sqm	1	0.00037252902984619140625	0.00037252902984619140625
31	Construction of 0.0000037252902984619140625 sqm	1	0.000186264514923095703125	0.000186264514923095703125
32	Construction of 0.00000186264514923095703125 sqm	1	0.0000931322574615478515625	0.0000931322574615478515625
33	Construction of 0.000000931322574615478515625 sqm	1	0.00004656612873077392578125	0.00004656612873077392578125
34	Construction of 0.0000004656612873077392578125 sqm	1	0.000023283064365386962890625	0.000023283064365386962890625
35	Construction of 0.00000023283064365386962890625 sqm	1	0.0000116415321826934814453125	0.0000116415321826934814453125
36	Construction of 0.000000116415321826934814453125 sqm	1	0.00000582076609134674072265625	0.00000582076609134674072265625
37	Construction of 0.0000000582076609134674072265625 sqm	1	0.000002910383045673370361328125	0.000002910383045673370361328125
38	Construction of 0.00000002910383045673370361328125 sqm	1	0.0000014551915228366851806640625	0.0000014551915228366851806640625
39	Construction of 0.000000014551915228366851806640625 sqm	1	0.00000072759576141834259033203125	0.00000072759576141834259033203125
40	Construction of 0.0000000072759576141834259033203125 sqm	1	0.000000363797880709171295166015625	0.000000363797880709171295166015625
41	Construction of 0.00000000363797880709171295166015625 sqm	1	0.0000001818989403545856475830078125	0.0000001818989403545856475830078125
42	Construction of 0.000000001818989403545856475830078125 sqm	1	0.00000009094947017729282379150390625	0.00000009094947017729282379150390625
43	Construction of 0.0000000009094947017729282379150390625 sqm	1	0.000000045474735088646411895751953125	0.000000045474735088646411895751953125
44	Construction of 0.00000000045474735088646411895751953125 sqm	1	0.0000000227373675443232059478759765625	0.0000000227373675443232059478759765625
45	Construction of 0.000000000227373675443232059478759765625 sqm	1	0.00000001136868377216160297393798828125	0.00000001136868377216160297393798828125
46	Construction of 0.0000000001136868377216160297393798828125 sqm	1	0.000000005684341886080801486968994140625	0.000000005684341886080801486968994140625
47	Construction of 0.00000000005684341886080801486968994140625 sqm	1	0.0000000028421709430404007434844970703125	0.0000000028421709430404007434844970703125
48	Construction of 0.000000000028421709430404007434844970703125 sqm	1	0.00000000142108547152020037174224853515625	0.00000000142108547152020037174224853515625
49	Construction of 0.0000000000142108547152020037174224853515625 sqm	1	0.000000000710542735760100185871124267578125	0.000000000710542735760100185871124267578125
50	Construction of 0.00000000000710542735760100185871124267578125 sqm	1	0.0000000003552713678800500929355621337890625	0.0000000003552713678800500929355621337890625



15774-4

10000
20' x 14'

10000
20' x 14'



10000
20' x 14'

15774-3

10000
20' x 14'

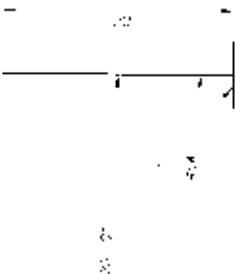

10000
20' x 14'

15774-2

10000
20' x 14'

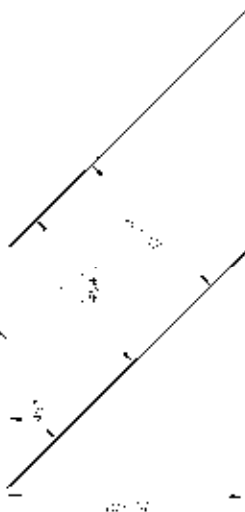

10000
20' x 14'

15774-1

10000
20' x 14'



10000
20' x 14'



UNIVERSITY OF CALIFORNIA, SAN DIEGO

Department of Planning and Urban Design
10000
20' x 14'

10000
20' x 14'

10000
20' x 14'

10000
20' x 14'

10000
20' x 14'

10000
20' x 14'

10000
20' x 14'

10000
20' x 14'

10000
20' x 14'

10000
20' x 14'

10000
20' x 14'

STATEMENT OF WORKING CAPITAL

1. THE COMPANY HAS INVESTED IN THE FOLLOWING ASSETS:
 (a) LAND AND BUILDINGS IN THE CITY OF NEW YORK
 (b) EQUIPMENT AND FURNITURE
 (c) STOCKS AND BONDS
 (d) CASH AND OTHER ASSETS

2. THE COMPANY HAS INCURRED THE FOLLOWING LIABILITIES:
 (a) ACCOUNTS PAYABLE
 (b) BANK LOANS
 (c) OTHER LIABILITIES

3. THE COMPANY HAS A NET WORKING CAPITAL OF \$100,000.

4. THE COMPANY HAS A NET ASSET VALUE OF \$100,000.

5. THE COMPANY HAS A NET EQUITY OF \$100,000.

6. THE COMPANY HAS A NET DEBT OF \$0.

7. THE COMPANY HAS A NET ASSET VALUE OF \$100,000.

8. THE COMPANY HAS A NET EQUITY OF \$100,000.

9. THE COMPANY HAS A NET ASSET VALUE OF \$100,000.

10. THE COMPANY HAS A NET EQUITY OF \$100,000.

ASSETS	LIABILITIES	EQUITY
Land and Buildings	Accounts Payable	Common Stock
Equipment and Furniture	Bank Loans	Retained Earnings
Stocks and Bonds	Other Liabilities	
Cash and Other Assets		
Total	Total	Total

40,000	
100,000	
140,000	
140,000	
140,000	
140,000	

100,000	
100,000	
100,000	
100,000	
100,000	
100,000	

100,000	
100,000	
100,000	
100,000	
100,000	
100,000	

100,000	
100,000	
100,000	
100,000	
100,000	
100,000	

100,000	
100,000	
100,000	
100,000	
100,000	
100,000	



NIST
 National Institute of Standards and Technology
 Gaithersburg, MD 20899
 Telephone: 301-975-3000
 Fax: 301-975-2856
 E-mail: nist@nist.gov
 WWW: www.nist.gov

Match Line 23+00.00 DWG NO. T-12

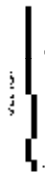

22

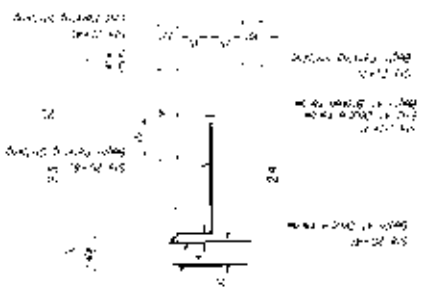

61

Note:
 Use Detail T-12
 For Existing Building Details

Sheet 1 of 1



13-00-00 DWG NO. 1-31
 STATE OF CALIFORNIA
 COUNTY OF LOS ANGELES

STOP
 ALL TRAFFIC
 MUST STOP
 AT THIS SIGN

13-00-00 DWG NO. 1-31
 STATE OF CALIFORNIA
 COUNTY OF LOS ANGELES

13-00-00 DWG NO. 1-31
 STATE OF CALIFORNIA
 COUNTY OF LOS ANGELES

13-00-00 DWG NO. 1-31
 STATE OF CALIFORNIA
 COUNTY OF LOS ANGELES

13-00-00 DWG NO. 1-31
 STATE OF CALIFORNIA
 COUNTY OF LOS ANGELES

13-00-00 DWG NO. 1-31
 STATE OF CALIFORNIA
 COUNTY OF LOS ANGELES

13-00-00 DWG NO. 1-31
 STATE OF CALIFORNIA
 COUNTY OF LOS ANGELES



STOP

Match line Sta 23+00.00 DWG No. 1-31

13-00-00 DWG NO. 1-31
 STATE OF CALIFORNIA
 COUNTY OF LOS ANGELES



NATIONAL BUREAU OF STANDARDS
 4300 RAYBURN DRIVE
 GAITHERSBURG, MARYLAND 20885
 (301) 975-3000

NATIONAL BUREAU OF STANDARDS
 4300 RAYBURN DRIVE
 GAITHERSBURG, MARYLAND 20885
 (301) 975-3000

NATIONAL BUREAU OF STANDARDS
 4300 RAYBURN DRIVE
 GAITHERSBURG, MARYLAND 20885
 (301) 975-3000

NATIONAL BUREAU OF STANDARDS
 4300 RAYBURN DRIVE
 GAITHERSBURG, MARYLAND 20885
 (301) 975-3000

NATIONAL BUREAU OF STANDARDS
 4300 RAYBURN DRIVE
 GAITHERSBURG, MARYLAND 20885
 (301) 975-3000

NATIONAL BUREAU OF STANDARDS
 4300 RAYBURN DRIVE
 GAITHERSBURG, MARYLAND 20885
 (301) 975-3000

Match Line STA 13+00 Dwg No. 1 3A

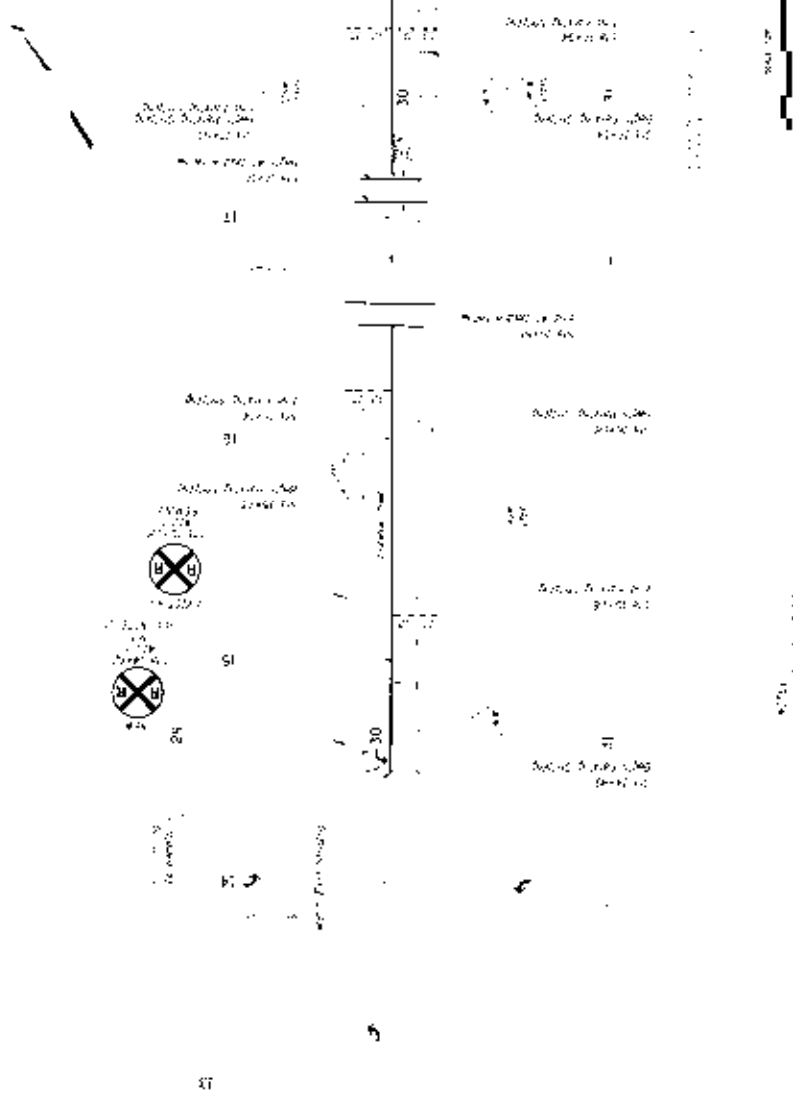

Scale 1" = 30'

NATIONAL BUREAU OF STANDARDS
 4300 RAYBURN DRIVE
 GAITHERSBURG, MARYLAND 20885
 (301) 975-3000



FEDERAL BUREAU OF INVESTIGATION
 DEPARTMENT OF JUSTICE
 WASHINGTON, D. C. 20535
 FORM NO. 1
 (REV. 11-27-70)

SCALE

MATCH LINE 54-00 00+22 D+5 94.7 4.37M

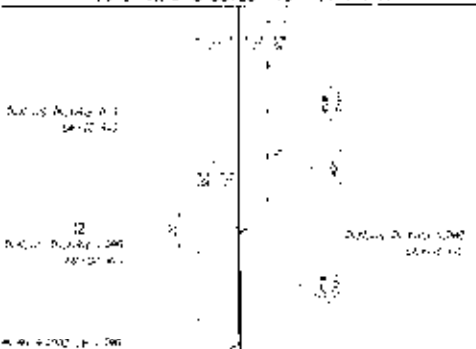

00

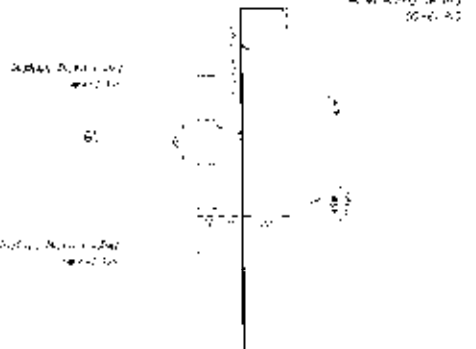

MATCH LINE 54-00 00+22 D+5 94.7 4.37M

SEE PLAN SHEET 54-00 00+22 D+5 94.7 4.37M

SEE PLAN SHEET 54-00 00+22 D+5 94.7 4.37M



STATE OF TEXAS
 DEPARTMENT OF TRANSPORTATION
 DIVISION OF HIGHWAYS
 PROJECT NO. 0-10-100-000
 SECTION 01100 - PAVEMENT
 DRAWING NO. 10-100-000-000-000

CONTRACT NO. 0-10-100-000-000
 SHEET NO. 10-100-000-000-000

SCALE: 1" = 40'

MATCH LINE STA 18+00 TO STA 17+00

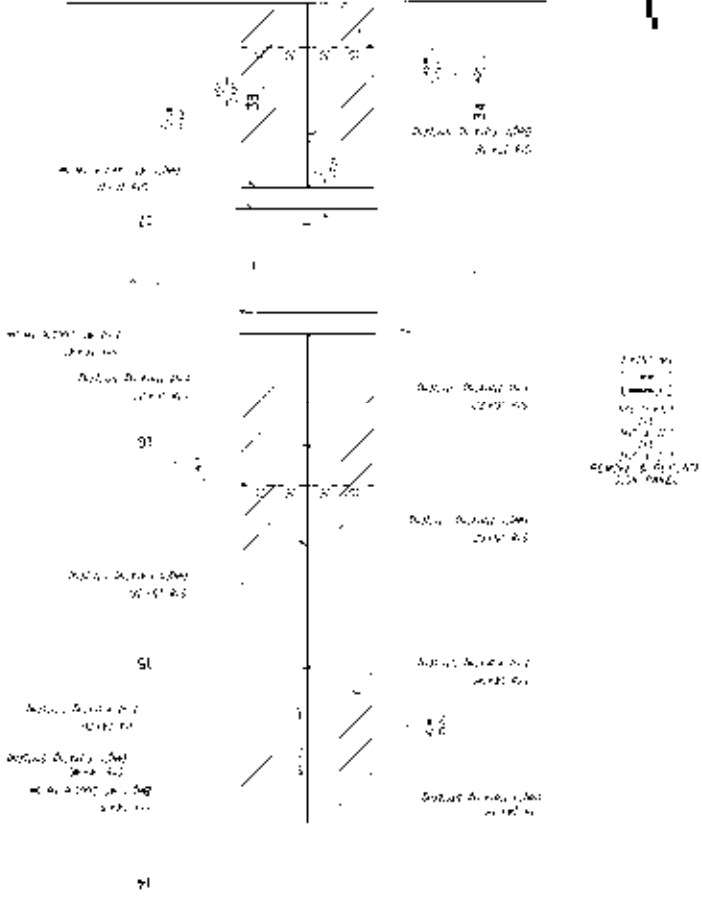

LEGEND:
 1" = 40'
 1" = 10'
 1" = 20'
 1" = 30'
 1" = 40'
 1" = 50'
 1" = 60'
 1" = 70'
 1" = 80'
 1" = 90'
 1" = 100'



FEDERAL ROAD BOARD
 NATIONAL HIGHWAY TRAFFIC SAFETY ADMINISTRATION
 U.S. DEPARTMENT OF TRANSPORTATION
 WASHINGTON, D.C. 20590

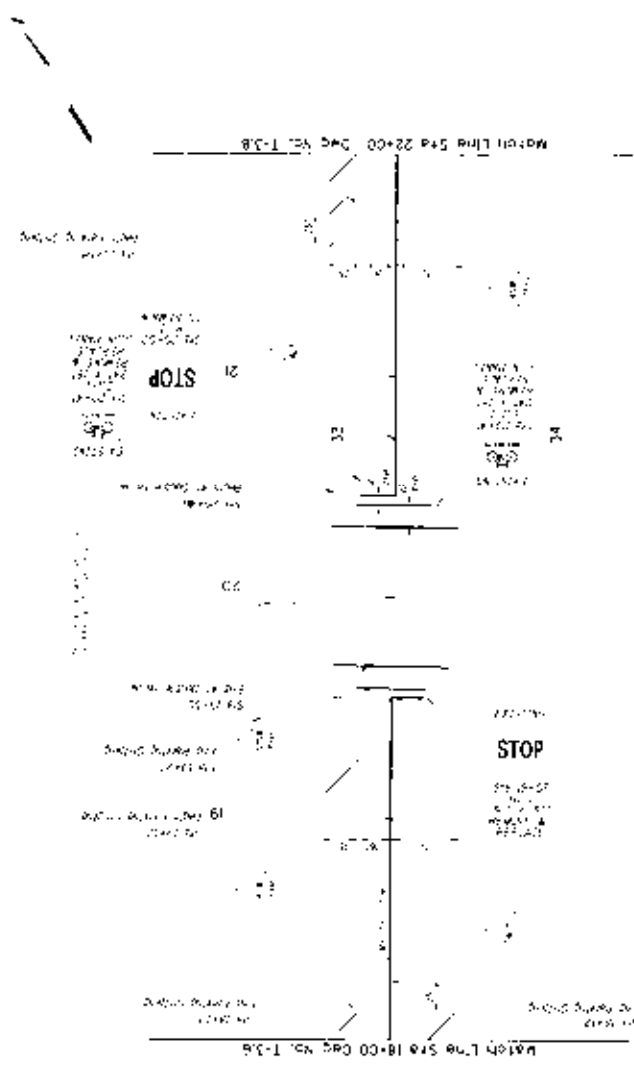

THIS DRAWING IS THE PROPERTY OF THE NATIONAL HIGHWAY TRAFFIC SAFETY ADMINISTRATION. IT IS LOANED TO YOU AND IS NOT TO BE REPRODUCED OR TRANSMITTED IN ANY FORM OR BY ANY MEANS, ELECTRONIC OR MECHANICAL, INCLUDING PHOTOCOPYING, RECORDING, OR BY ANY INFORMATION STORAGE AND RETRIEVAL SYSTEM.



100-108-01

NATIONAL BUREAU OF STANDARDS
 430 RIVERSIDE DRIVE
 GAITHERSBURG, MARYLAND 20885
 U.S. GOVERNMENT PRINTING OFFICE: 1975 O 250-108



100-108-01

USAF-OR-100 STA 37-00 DWG NO. 1 212

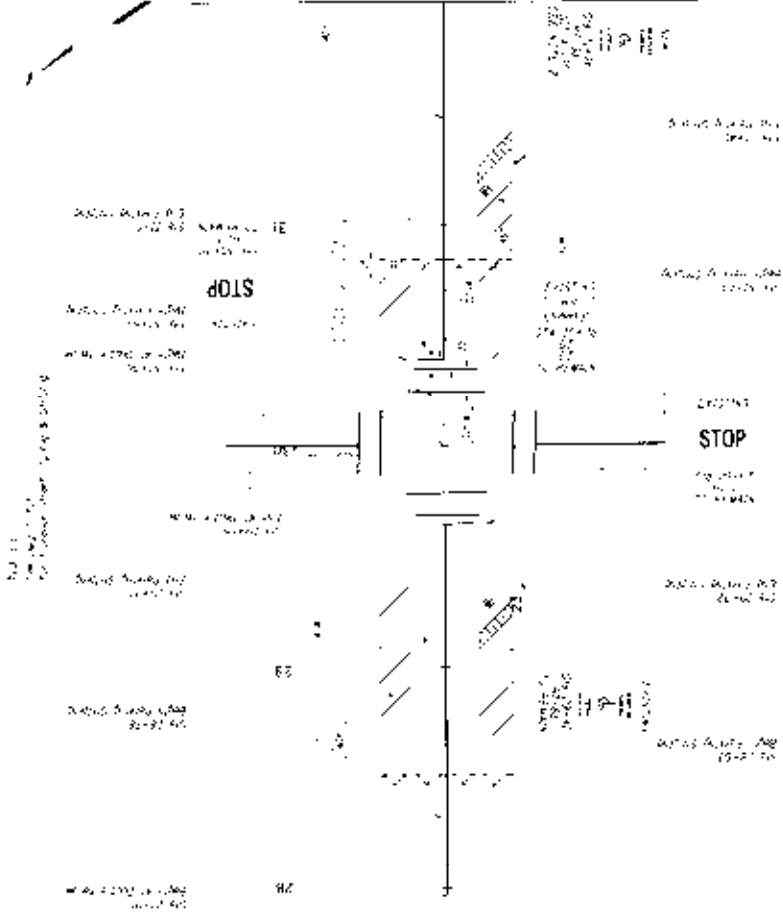

1. See DWG NO. 100-108-01 for component locations.
 2. Approximate pin locations.

1. See DWG NO. 100-108-01 for component locations.
 2. Approximate pin locations.

1. See DWG NO. 100-108-01 for component locations.
 2. Approximate pin locations.

1. See DWG NO. 100-108-01 for component locations.
 2. Approximate pin locations.



STATE OF MARYLAND
 DEPARTMENT OF TRANSPORTATION
 DIVISION OF HIGHWAYS
 2400 LEHIGH AVENUE, BALTIMORE, MD 21218
 PROJECT NO. 70-100-100-100-100
 DRAWING NO. 70-100-100-100-100

CONTRACT NO. 70-100-100-100-100
 SHEET NO. 100-100-100-100-100

DATE: 10/1/70
 DRAWN BY: [Name]
 CHECKED BY: [Name]
 2.400 LEHIGH AVENUE, BALTIMORE, MD 21218

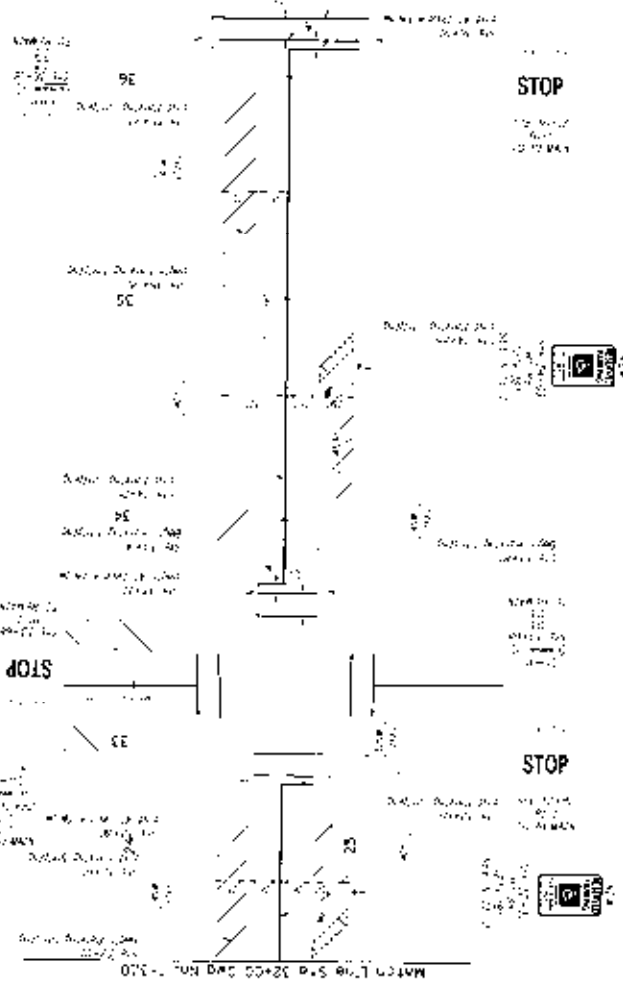

CONTRACT NO. 70-100-100-100-100
 SHEET NO. 100-100-100-100-100



U.S. DEPARTMENT OF ENERGY
 OFFICE OF ENERGY EFFICIENCY AND RENEWABLE ENERGY
 1000 POWER BUILDING
 WASHINGTON, D.C. 20545
 ENERGY EFFICIENCY REPORT

PROJECT NUMBER: 1000-1000-1000
 PROJECT TITLE: ENERGY EFFICIENCY REPORT

1000-1000-1000

12

13

14

15



1000-1000-1000

1000-1000-1000



Plant Schedule

Plant Species	Quantity	Planting Date	Planting Location
SPRUELS	10	11/11/11	Along sidewalk
SPRUELS	10	11/11/11	Along sidewalk
SPRUELS	10	11/11/11	Along sidewalk
SPRUELS	10	11/11/11	Along sidewalk
SPRUELS	10	11/11/11	Along sidewalk
SPRUELS	10	11/11/11	Along sidewalk
SPRUELS	10	11/11/11	Along sidewalk
SPRUELS	10	11/11/11	Along sidewalk
SPRUELS	10	11/11/11	Along sidewalk
SPRUELS	10	11/11/11	Along sidewalk

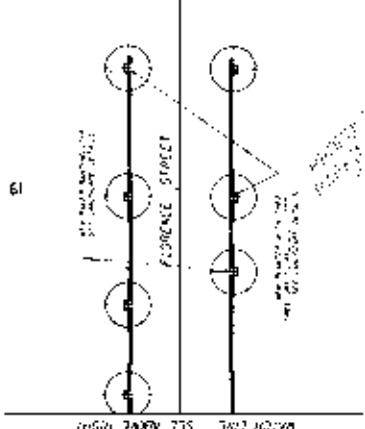
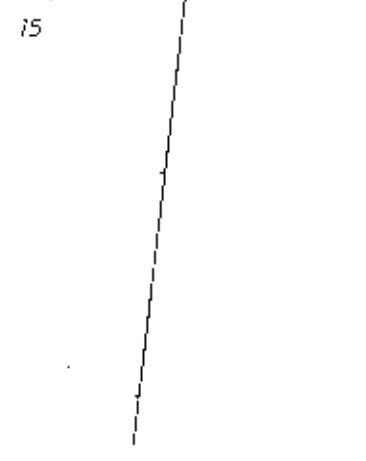
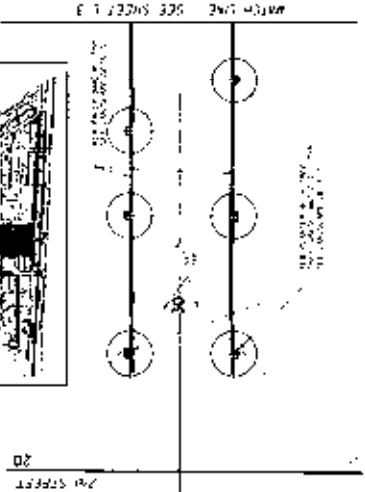
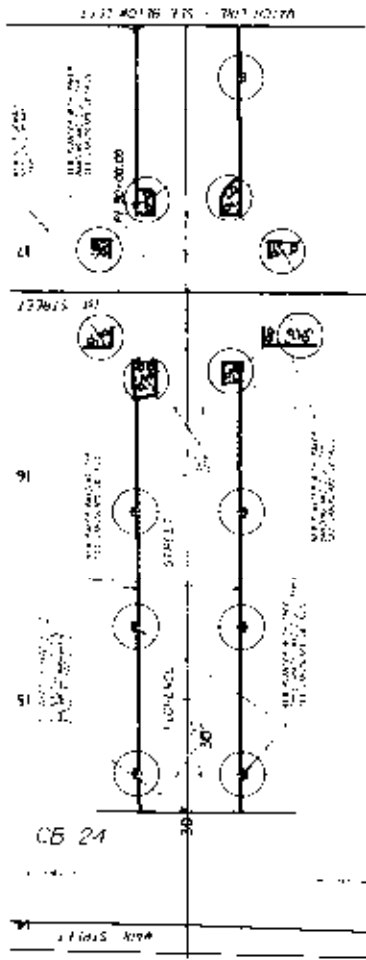

11/11/11

11/11/11

11/11/11

11/11/11

CB 24

15

20

61

11/11/11 11/11/11

10/10/66
 10/10/66

City of Los Angeles
 Department of Public Works
 Bureau of Street Design
 100 South Los Angeles Street
 Los Angeles, California 90012

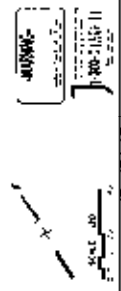

Plant Schedule

Symbol	Plant	Quantity	Notes
(Circle with 'S')	SMALL TREES	1	Plant at 10' intervals
(Circle with 'M')	MEDIUM TREES	1	Plant at 20' intervals
(Circle with 'L')	LARGE TREES	1	Plant at 40' intervals
(Circle with 'B')	BUSHES	1	Plant at 10' intervals
(Circle with 'F')	FLOWERING TREES	1	Plant at 20' intervals
(Circle with 'P')	PERENNIALS	1	Plant at 10' intervals
(Circle with 'G')	GRASSES	1	Plant at 10' intervals
(Circle with 'C')	COVER CROPS	1	Plant at 10' intervals
(Circle with 'R')	ROCKS	1	Plant at 10' intervals
(Circle with 'D')	DRY BRUSH	1	Plant at 10' intervals
(Circle with 'W')	WATER PLANTS	1	Plant at 10' intervals

Notes:
 1. ALL PLANTS TO BE PLANTED AT THE END OF THE PLANTING PERIOD.
 2. ALL PLANTS TO BE PLANTED AT THE END OF THE PLANTING PERIOD.

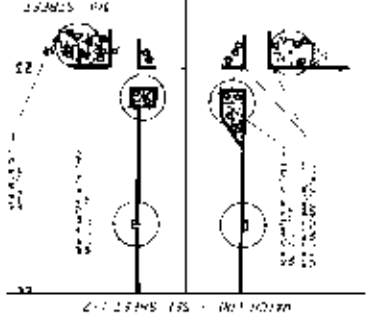
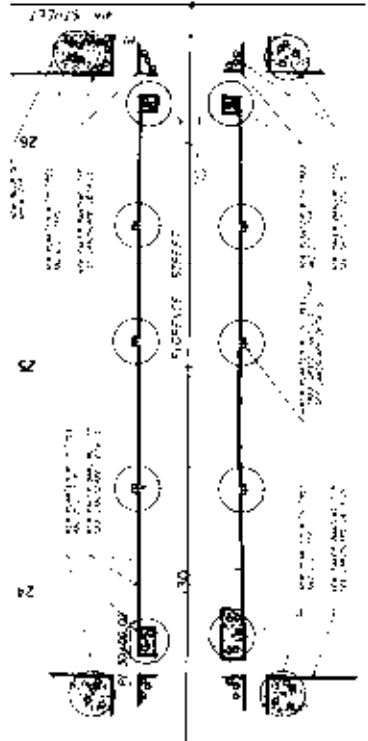
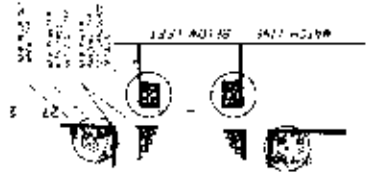
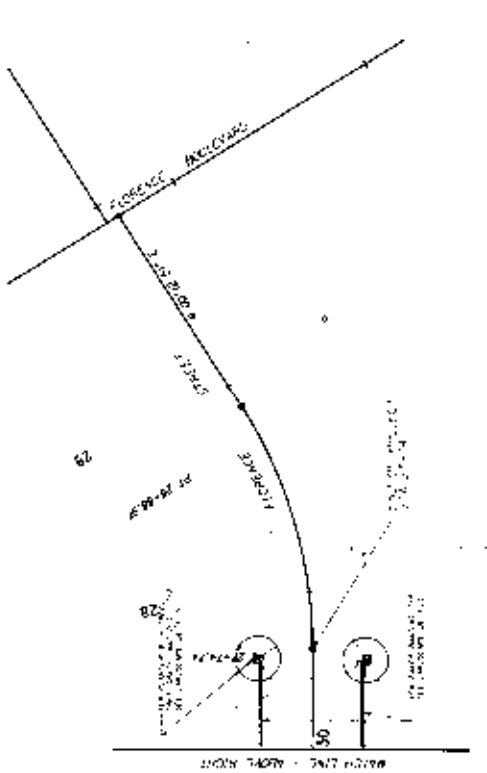

2
 10/10/66
 10/10/66

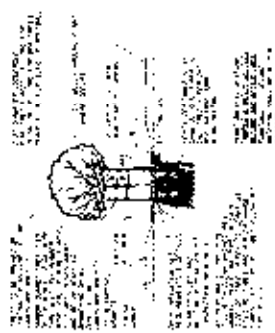

① TREE PLANTING IN D.G. AREAS

1. TREE PLANTING IN D.G. AREAS

2. TREE PLANTING IN D.G. AREAS

3. TREE PLANTING IN D.G. AREAS

4. TREE PLANTING IN D.G. AREAS

5. TREE PLANTING IN D.G. AREAS

6. TREE PLANTING IN D.G. AREAS

7. TREE PLANTING IN D.G. AREAS

8. TREE PLANTING IN D.G. AREAS

9. TREE PLANTING IN D.G. AREAS

10. TREE PLANTING IN D.G. AREAS

① TREE PLANTING IN D.G. AREAS



② GROUNDER PLANTING

1. GROUNDER PLANTING

2. GROUNDER PLANTING

3. GROUNDER PLANTING

4. GROUNDER PLANTING

5. GROUNDER PLANTING

6. GROUNDER PLANTING

7. GROUNDER PLANTING

8. GROUNDER PLANTING

9. GROUNDER PLANTING

10. GROUNDER PLANTING

② GROUNDER PLANTING



③ SHRUB PLANTING

1. SHRUB PLANTING

2. SHRUB PLANTING

3. SHRUB PLANTING

4. SHRUB PLANTING

5. SHRUB PLANTING

6. SHRUB PLANTING

7. SHRUB PLANTING

8. SHRUB PLANTING

9. SHRUB PLANTING

10. SHRUB PLANTING

③ SHRUB PLANTING

DATE: 11/15/11
BY: [Signature]

11/15/11
11:15 AM
11/15/11
11:15 AM



11/15/11
11:15 AM
11/15/11
11:15 AM

11/15/11
11:15 AM
11/15/11
11:15 AM

11/15/11
11:15 AM
11/15/11
11:15 AM

11/15/11
11:15 AM
11/15/11
11:15 AM

11/15/11
11:15 AM
11/15/11
11:15 AM

11/15/11
11:15 AM
11/15/11
11:15 AM

11/15/11
11:15 AM
11/15/11
11:15 AM

11/15/11
11:15 AM
11/15/11
11:15 AM

11/15/11
11:15 AM
11/15/11
11:15 AM

11/15/11
11:15 AM
11/15/11
11:15 AM

11/15/11
11:15 AM
11/15/11
11:15 AM

11/15/11
11:15 AM
11/15/11
11:15 AM

11/15/11
11:15 AM
11/15/11
11:15 AM

11/15/11
11:15 AM
11/15/11
11:15 AM

11/15/11
11:15 AM
11/15/11
11:15 AM

11/15/11
11:15 AM
11/15/11
11:15 AM

11/15/11
11:15 AM
11/15/11
11:15 AM



CITY OF LOS ANGELES
 505 WEST 12TH STREET
 LOS ANGELES, CALIF. 90007

2
 2
 2

11/27/2011
 11/27/2011



1725047500 1725047500

Code	Description
1	1" = 10' SCALE
2	2" = 10' SCALE
3	3" = 10' SCALE
4	4" = 10' SCALE
5	5" = 10' SCALE
6	6" = 10' SCALE
7	7" = 10' SCALE
8	8" = 10' SCALE
9	9" = 10' SCALE
10	10" = 10' SCALE
11	11" = 10' SCALE
12	12" = 10' SCALE
13	13" = 10' SCALE
14	14" = 10' SCALE
15	15" = 10' SCALE
16	16" = 10' SCALE
17	17" = 10' SCALE
18	18" = 10' SCALE
19	19" = 10' SCALE
20	20" = 10' SCALE
21	21" = 10' SCALE
22	22" = 10' SCALE
23	23" = 10' SCALE
24	24" = 10' SCALE
25	25" = 10' SCALE
26	26" = 10' SCALE
27	27" = 10' SCALE
28	28" = 10' SCALE
29	29" = 10' SCALE
30	30" = 10' SCALE
31	31" = 10' SCALE
32	32" = 10' SCALE
33	33" = 10' SCALE
34	34" = 10' SCALE
35	35" = 10' SCALE
36	36" = 10' SCALE
37	37" = 10' SCALE
38	38" = 10' SCALE
39	39" = 10' SCALE
40	40" = 10' SCALE
41	41" = 10' SCALE
42	42" = 10' SCALE
43	43" = 10' SCALE
44	44" = 10' SCALE
45	45" = 10' SCALE
46	46" = 10' SCALE
47	47" = 10' SCALE
48	48" = 10' SCALE
49	49" = 10' SCALE
50	50" = 10' SCALE
51	51" = 10' SCALE
52	52" = 10' SCALE
53	53" = 10' SCALE
54	54" = 10' SCALE
55	55" = 10' SCALE
56	56" = 10' SCALE
57	57" = 10' SCALE
58	58" = 10' SCALE
59	59" = 10' SCALE
60	60" = 10' SCALE
61	61" = 10' SCALE
62	62" = 10' SCALE
63	63" = 10' SCALE
64	64" = 10' SCALE
65	65" = 10' SCALE
66	66" = 10' SCALE
67	67" = 10' SCALE
68	68" = 10' SCALE
69	69" = 10' SCALE
70	70" = 10' SCALE
71	71" = 10' SCALE
72	72" = 10' SCALE
73	73" = 10' SCALE
74	74" = 10' SCALE
75	75" = 10' SCALE
76	76" = 10' SCALE
77	77" = 10' SCALE
78	78" = 10' SCALE
79	79" = 10' SCALE
80	80" = 10' SCALE
81	81" = 10' SCALE
82	82" = 10' SCALE
83	83" = 10' SCALE
84	84" = 10' SCALE
85	85" = 10' SCALE
86	86" = 10' SCALE
87	87" = 10' SCALE
88	88" = 10' SCALE
89	89" = 10' SCALE
90	90" = 10' SCALE
91	91" = 10' SCALE
92	92" = 10' SCALE
93	93" = 10' SCALE
94	94" = 10' SCALE
95	95" = 10' SCALE
96	96" = 10' SCALE
97	97" = 10' SCALE
98	98" = 10' SCALE
99	99" = 10' SCALE
100	100" = 10' SCALE

